

Induction High Bay Series



Features : 03-022

Protection class: IP54

High Pressure die-casting aluminium electrical round box

Electrostatic spray surface, high reflectivity, stable optical properties

Toughened glass with high light transmission

Polished high purity aluminium oxide reflector



Photometrics

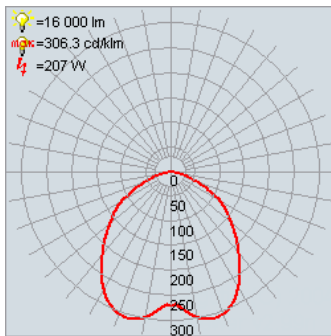

Technical details

Lamp Specifications

Lamp Wattage	Luminous Flux	Pupil Lumens	CRI	Colour Temp.	Lamp life span
80 W	6400	10368	80-85	5000 k	80,000 hrs
120 W	9600	15550			
150 W	12000	19440			
200 W	16000	25920			

Ballast Specifications

System Wattage	Input Voltage	Input Current (amps)	THD	Ambient temp.	Power factor
80 W	110 – 277 Vac	0.40	<10%	-10 to 30 deg C	>0.98
120 W		0.59			
150 W		0.74			
200 W		0.95			

Dimensions

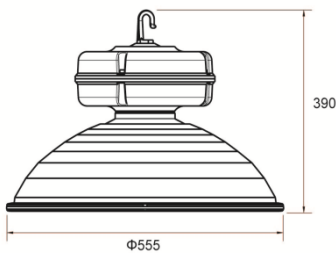

Wattage	Dimensions
80W 120W 150W 200W	550 x 400
Estimated Weight : 5KG	

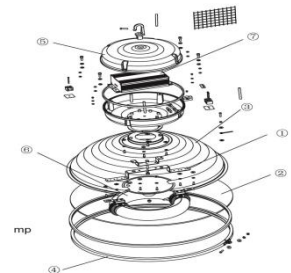

Applications



Industrial factory
Warehouses
Stadium
Hypermarkets,
Stadium
Other indoor environments



Eco Green LVD (S) Pte Ltd

Biz & GST Reg. No. 201117549C

18 Boon Lay Way #08-104 TradeHub 21 Singapore 609966

Tel: 6795 2168 Fax: 6795 6361

Videos: www.youtube.com/EcoGreenLVD

Website: www.ecogreenlvd.com

Ordering Information

Series

Eco Green LVD 03-022



Wattage

80W
120W
150W
200W



Voltage

110 – 110to277V
200 – 200to240V



Color Temp

50-5000k
35-3500k
65-6500k



Cover

TG-Tempered Glass
PC-Polycarbonate Clear



Special



Bold = Standard

Grey* = Upgrade options available upon request

Example : Eco Green LVD 03-022-200-110-50-TG

Mounting Method / Installation Procedures



Unload the four buckles with slotted screwdriver, remove the metal wire net.



Unscrew the hoop and take out the hoop, rubber seal and glass.



Take out the anti-vibration pad beside the bulb with your hand, and at the meantime you need to make the bulb into normal state, not skew.



Put the glass into the hoop and Wrap the glass and cover edge together with rubber seal.



Cover the hoop, use the screw to fasten the hoop (Attention: the opening of the hoop is on the opposite of the seal tape connection, and if necessary beat around the hoop to make it tightly.)



Unscrew the screws which on the Electrical Box cover with screwdriver.



Tighten the hook on the ballast housing of the fixture, feed the power line into the ballast housing through the opening of the hook, cover the power line with 2 pcs of the rubber seal rings.

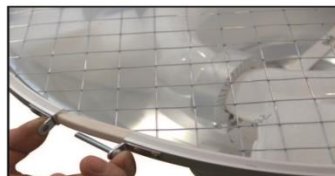

Put on the washers and fasten the nut, the exposed power line is around 250mm long.

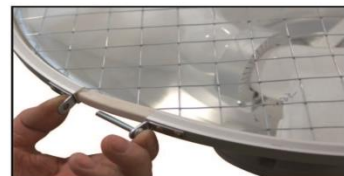

Connect the power cord into the 3-row 6-hole connecting terminal according to the connecting label. Pin the power cord with the pin board.



Unscrew the screw which on the hoop.



Install the hoop on the right hole position



Tighten the screw which on the hoop to avoid the loss angle iron parameters (Size: 4cm×4cm×10cm, Aperture: ≥12mm, Bear load: ≥ 5 times the weight of lamps and lanterns)



CERT NO.: OHS-S5 506-XXXX
S5 506 : Part 1 : 2009



CERT NO.: OHS-XXXX-XXXX
S5 OHSAS 18001 : 2007



CERT NO.: XX-X-XXXX
ISO 9001 : 2008



Eco Green LVD (S) Pte Ltd

Biz & GST Reg. No. 201117549C

18 Boon Lay Way #08-104 TradeHub 21 Singapore 609966

Tel: 6795 2168 Fax: 6795 6361

Videos: www.youtube.com/EcoGreenLVD

Website: www.ecogreenlvd.com